

# Accessing Workspace virtual applications-On Campus/SU computer

1. Browse to <https://workspace.salisbury.edu> via your internet browser
2. In the upper right-hand corner, click on your name and use the drop down to navigate and click on **Settings**

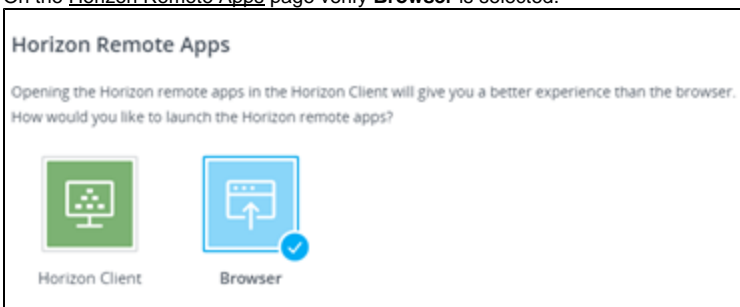

3. On the left side of the page, select **Preferences**
4. On the [Horizon Remote Apps](#) page verify **Browser** is selected.



5. Select the Back button to go back to the list of applications
6. Select the application you wish to use and continue.

## Related articles

- [Open and save files using Workspace virtual applications](#)
- [Accessing Workspace virtual applications-On Campus/SU computer](#)
- [Accessing Workspace virtual applications-Off Campus/Personal Device](#)
- [Continuity of Duties in the Event of Remote Work](#)
- [Listing of Methods to Access SU On-Campus Resources \(VPN and Workspace\)](#)